

Weber Smokey Mountain Parts Schematics for Smokers 2000-2008

Weber Smokey Mountain Model Number 2820

<http://www.WeberReplacementParts.com>

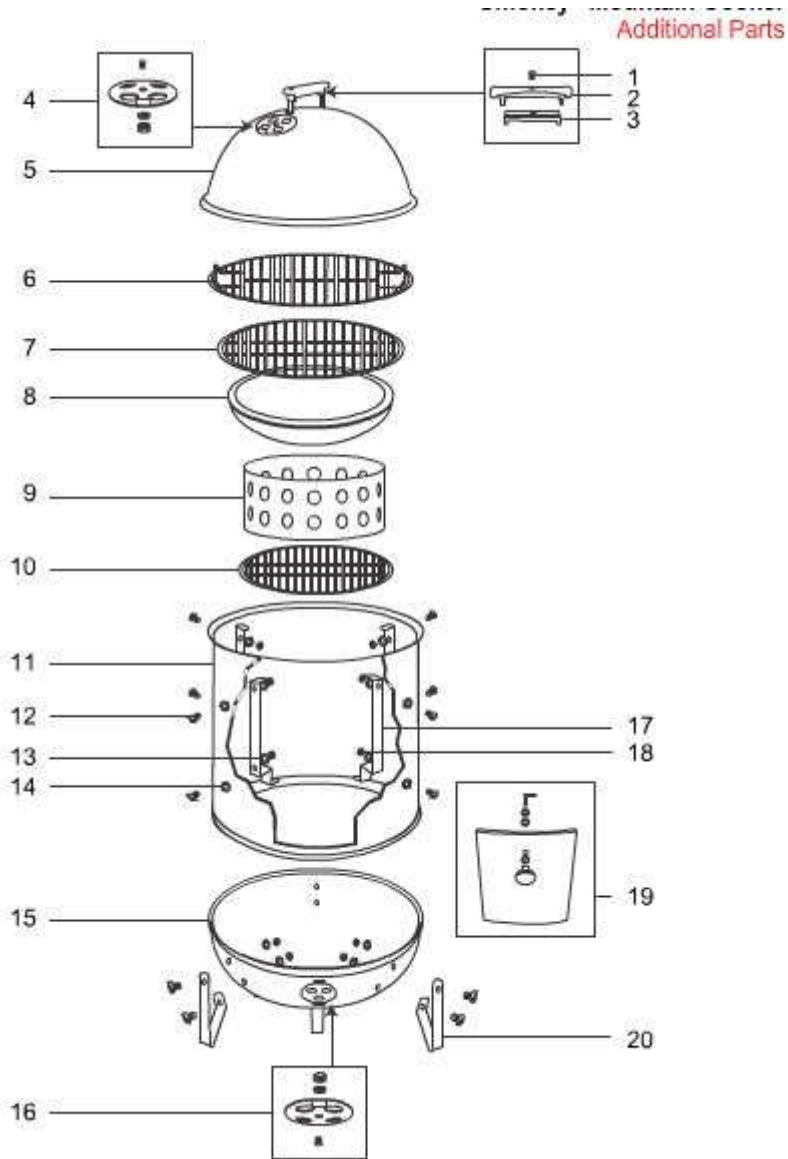

|           |       |   |
|-----------|-------|---|
| <u>1</u>  | 80671 | Handle kit, charcoal, qty 1, '10                        |
| <u>2</u>  | 80671 | Handle kit, charcoal, qty 1, '10                        |
| <u>3</u>  | 80671 | Handle kit, charcoal, qty 1, '10                        |
| <u>4</u>  | 87401 | Screw 1/4-20 x 5/8" slotted truss head, zinc            |
| <u>4</u>  | 87505 | Acorn nut 1/4-20 inch                                   |
| <u>4</u>  | 87605 | Flat washer 1/4 inch                                    |
| <u>4</u>  | 63015 | Damper kit, 18.5" Bar-B-Kettle & Smokey Mountain Cooker |
| <u>5</u>  | 63005 | Lid assembly, 18.5" Smokey Mountain Cooker, black, '09  |
| <u>6</u>  | 80634 | Cooking grate, 18.5", '10                               |
| <u>7</u>  | 80624 | Lower cooking grate, 18.5" Smokey Mountain Cooker, '10  |
| <u>8</u>  | 63024 | Water pan, 18" Smokey Mountain Cooker, '09              |
| <u>9</u>  | 63007 | Charcoal chamber, 18.5" Smokey Mountain Cooker          |
| <u>10</u> | 63013 | Charcoal grate, 18.5" Smokey Mountain Cooker            |
| <u>11</u> | 85039 | Center ring, 18" Smokey Mountain Cooker, black '14      |
| <u>12</u> | 87401 | Screw 1/4-20 x 5/8" slotted truss head, zinc            |
| <u>13</u> | 87605 | Flat washer 1/4 inch                                    |

|           |        |   |
|-----------|--------|---|
| <u>14</u> | 877301 | Flat fiber washer.265X.500X.062                                       |
| <u>15</u> | 63001  | Bowl for 18.5" Smokey Mountain Cooker, black                          |
| <u>16</u> | 87605  | Flat washer 1/4 inch  |
| <u>16</u> | 63015  | Damper kit, 18.5" Bar-B-Kettle & Smokey Mountain Cooker               |
| <u>16</u> | 87505  | Acorn nut 1/4-20 inch   |
| <u>16</u> | 87401  | Screw 1/4-20 x 5/8" slotted truss head, zinc                          |
| <u>17</u> | 63020  | Grill straps  |
| <u>18</u> | 87503  | Hex nut 1/4-20 inch, zinc   |
| <u>19</u> | 86901  | 10/24-inch hexagonal nut  |
| <u>19</u> | 875505 | Door knob   |
| <u>19</u> | 877401 | Door fastener, Smokey Mountain Cooker                                 |
| <u>19</u> | 877503 | Flat washer for Go-Anywhere Grills and Smokey Mountain Cooker Smoker. |
| <u>19</u> | 877601 | Lock washer (external tooth)  |
| <u>19</u> | 63018  | Door assembly   |
| <u>20</u> | 75801  | Leg for Smokey Mountain Cooker. 18-inch.                              |